

Fibreglass awnings that blend in with your home!

Manufactured by Dreamcast Fibreglass

## Installation Instruction

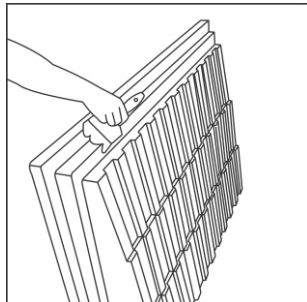

**Paint your awning in the colours of your choice.**

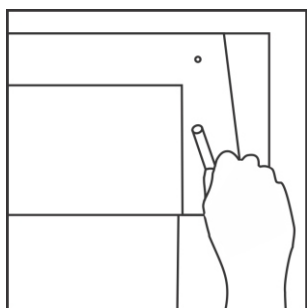

**Place awning into position and mark holes**

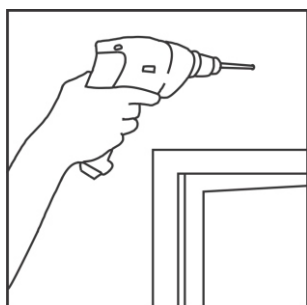

**Drill holes using an 8mm drill bit. And apply silicone sealant on the edge of the awning that is going to go against the wall.**

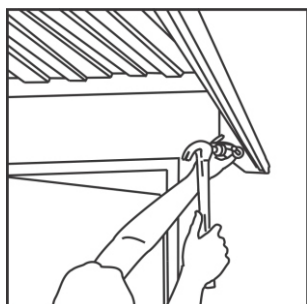

**Holding the awning in place, hammer in knock-in anchor nails.**

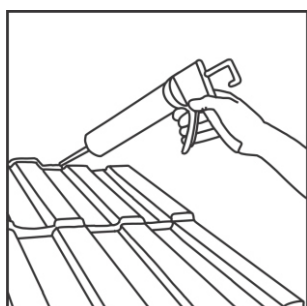

**Apply more silicone sealant in between the gap.**

**Please Note: All liability and responsibility (including any damage - personal or to property and/ or injury, theft , vandalism, violence, criminal acts, mass action, protests, acts of war or political action, pollution, extreme weather conditions, natural disasters, discoloration, cracking, peeling and chipping or any cracks/ star cracks. or acts of God) of the Awning will pass to the Buyer.**

**The Manufacturer's guarantee does not include installation or installation fittings and fixtures such as screws, brackets etc .**

Made in South Africa

